

**FEATURES**

- Locks in place after insertion
- Provides ease of injection and extraction of PCBs
- Front face marking optional
- Two pins furnished with each extractor
- Meets the requirements of drawing 83023, Defense Supply Center, Columbus (DSCC).

**MATERIAL**

**EXTRACTOR**

Type 6/6 Nylon per ASTM-D-4066, Type I

**PIN**

Stainless Steel, Passivated



Series 87 Locking Extractor

Meets DSCC 83023

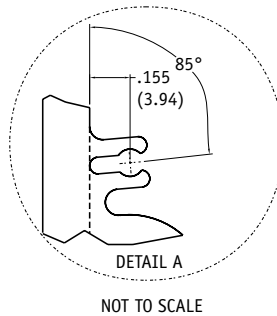
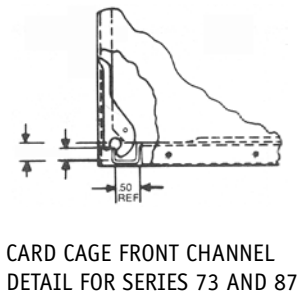
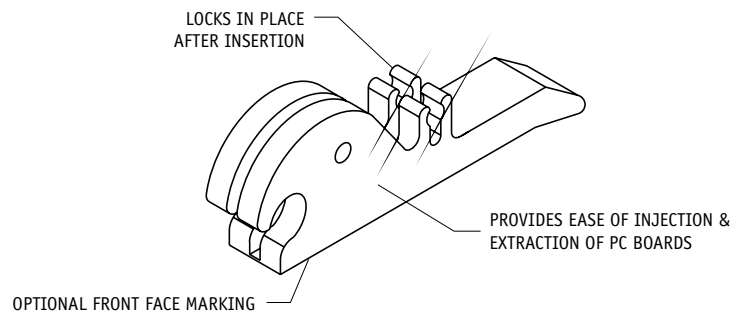

**NOTE ON DIMENSIONS:**  
ENGLISH LISTED FIRST  
FOLLOWED BY METRIC  
IN PARENTHESES

**TOLERANCES:**  
UNLESS OTHERWISE SPECIFIED  
.XXX(.XX)±.01(.25)  
.XX (.X) ±.02(.5)

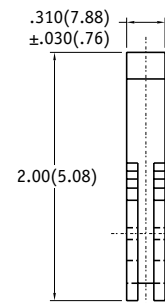
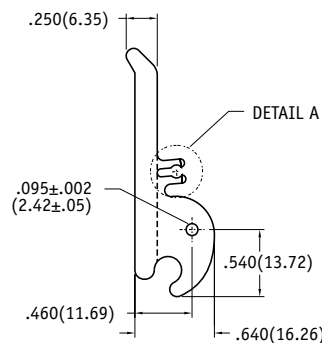
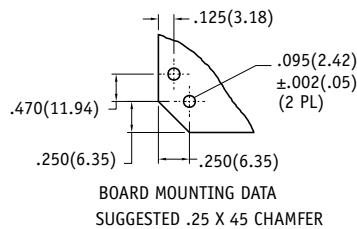
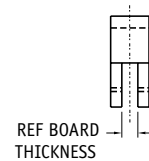

**Part Number Code** (See example below)

Series 87 Nylon Locking Extractor

87 -x -x

**Board Thickness**

Select a dash number from Board Thickness Table ②

**Color Finish**

Select dash number from Finish Table ①

**① FINISH TABLE**

COLORS ARE AN ADDITIONAL CHARGE

DASH #	COLOR
-1	RED
-2	BLUE
-3	GREEN
-4	YELLOW
-5	BLACK
-6	ORANGE
-7	VIOLET
-8	GRAY
-9	BROWN
NONE	NATURAL

**② BOARD THICKNESS TABLE**

DASH #	BOARD THICKNESS
-2	.063(1.60)
-3	.094(2.39)
-4	.125(3.18)

**Part Number Code example: 87-3-5**

Series 87 Extractor for .094(2.39) board, color Black.