

## FEATURES

- Series 91 are locking extractors
- Fire retardant
- Furnished with spring pins
- Mounting slot dimensions: .063 PCBs use .073

## MATERIAL

### EXTRACTOR

Nylon material  
MIL-M-206938 UL rated  
94V-2 (UL rated 94V-Ø available upon request)

### PIN

Stainless Steel, Passivated

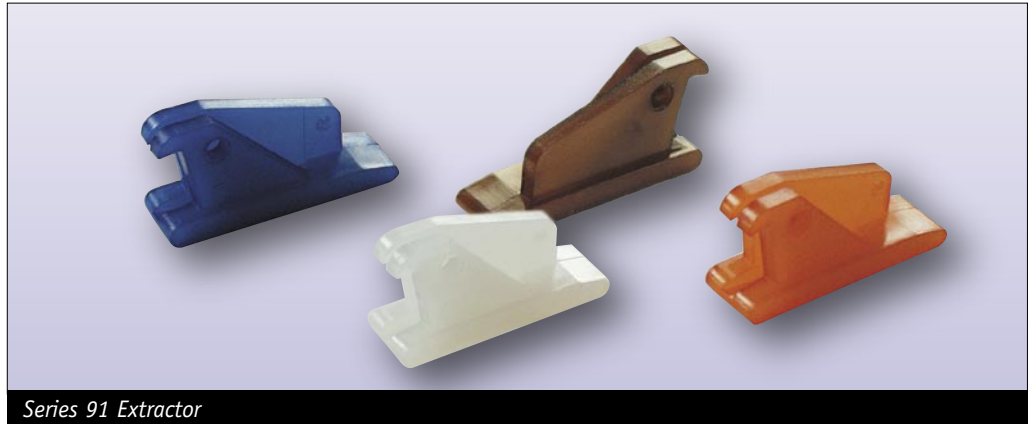

Series 91 Extractor

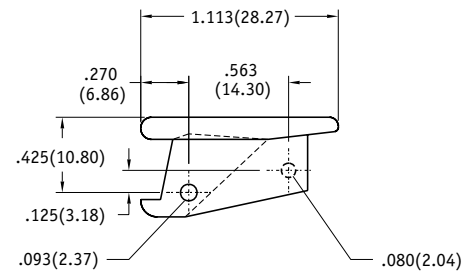
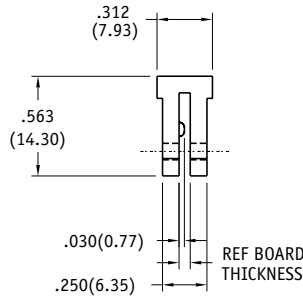
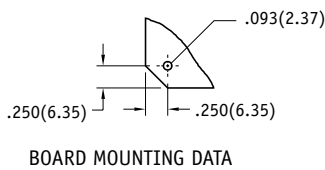
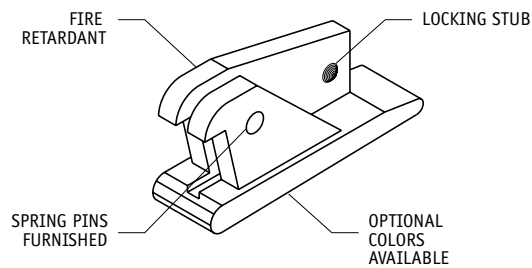

**NOTE ON DIMENSIONS:**  
ENGLISH LISTED FIRST  
FOLLOWED BY METRIC  
IN PARENTHESES

**TOLERANCES:**  
UNLESS OTHERWISE SPECIFIED  
.XXX(.XX)=±.01(.25)  
.XX (.X)=±.02(.50)

**Part Number Code** (See example below)

Series 91 Nylon Extractor

91 -x -x

### Board Thickness

Select a dash number from Board Thickness Table **2** \_\_\_\_\_

### Finish

Select dash number from Finish Table **1** \_\_\_\_\_

**Part Number Code example: 91-2-9**

Series 91 Extractor for .063(1.60) board, color Brown.

### 1 FINISH TABLE

COLORS ARE AN  
ADDITIONAL CHARGE

DASH #	COLOR
-1	RED
-2	BLUE
-3	GREEN
-4	YELLOW
-5	BLACK
-6	ORANGE
-7	VIOLET
-8	GRAY
-9	BROWN

### 2 BOARD THICKNESS TABLE

DASH #	BOARD THICKNESS
-2	.063(1.60)